

REVISIONS			
REV.	DESCRIPTION	DATE	APPROVED
Ø	INITIAL DRAWING RELEASE	12/07/99	MSP
A	REVISED TO GENERIC STANDARD PRODUCT	07/26/00	MSP
B	INITIAL SOLIDWORKS DRAWING RELEASE	04/23/12	JEH

NOTES: UNLESS OTHERWISE SPECIFIED

- DEBURR SHARP EDGES .015 MAX.
- CHAMFER ALL THREADS .01 PAST ROOT DIAMETER.
- REFLECTOR TO BE REPLICATED FROM SPECIFIED MASTER TOOL EXHIBITING REQUIRED GEOMETRY AND SPECULAR SURFACE FINISH OF 80-50 SCRATCH-DIG PER MIL-0-13830A.
- NOMINAL THICKNESS (T) MAY VARY ± T/4 WITHIN .25 OF EDGES.
- VERTEX HOLE OPENING IS PREFERRED REGISTRATION FEATURE FOR AXIAL ALIGNMENT OF REFLECTOR. PLANE OF CLEAR APERTURE NOT RECOMMENDED FOR THIS PURPOSE.

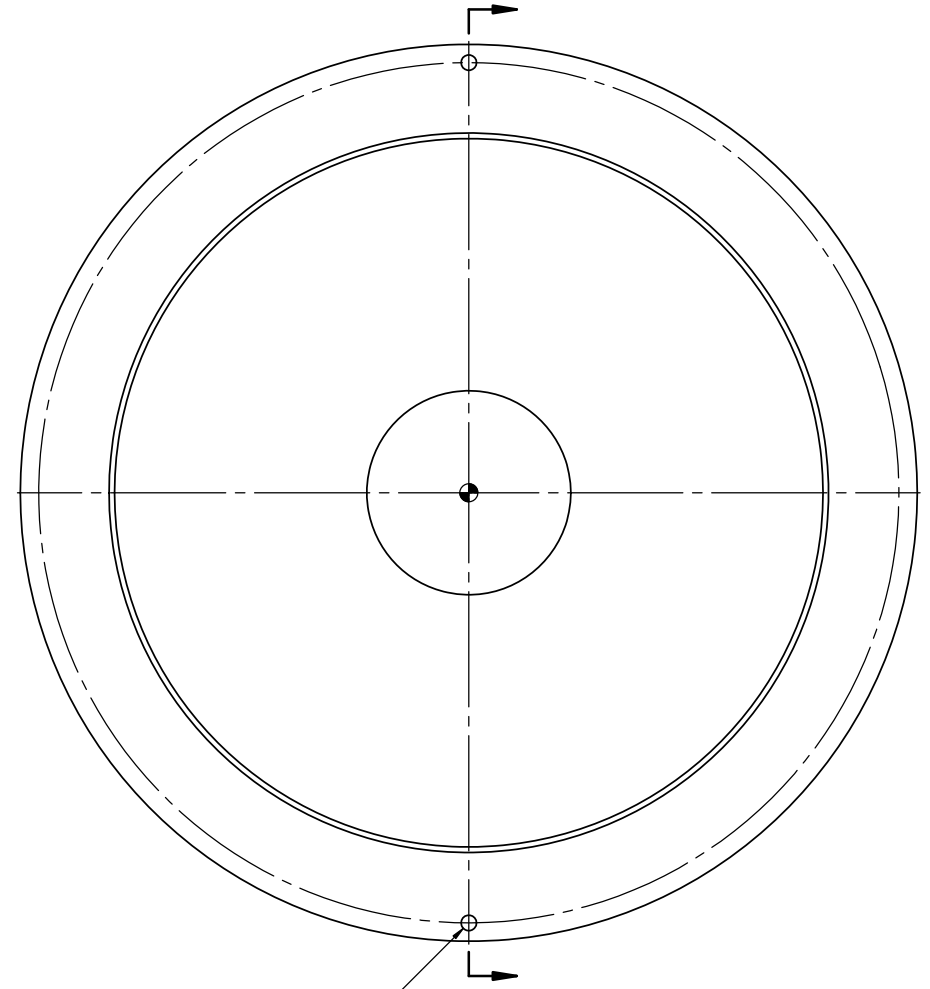
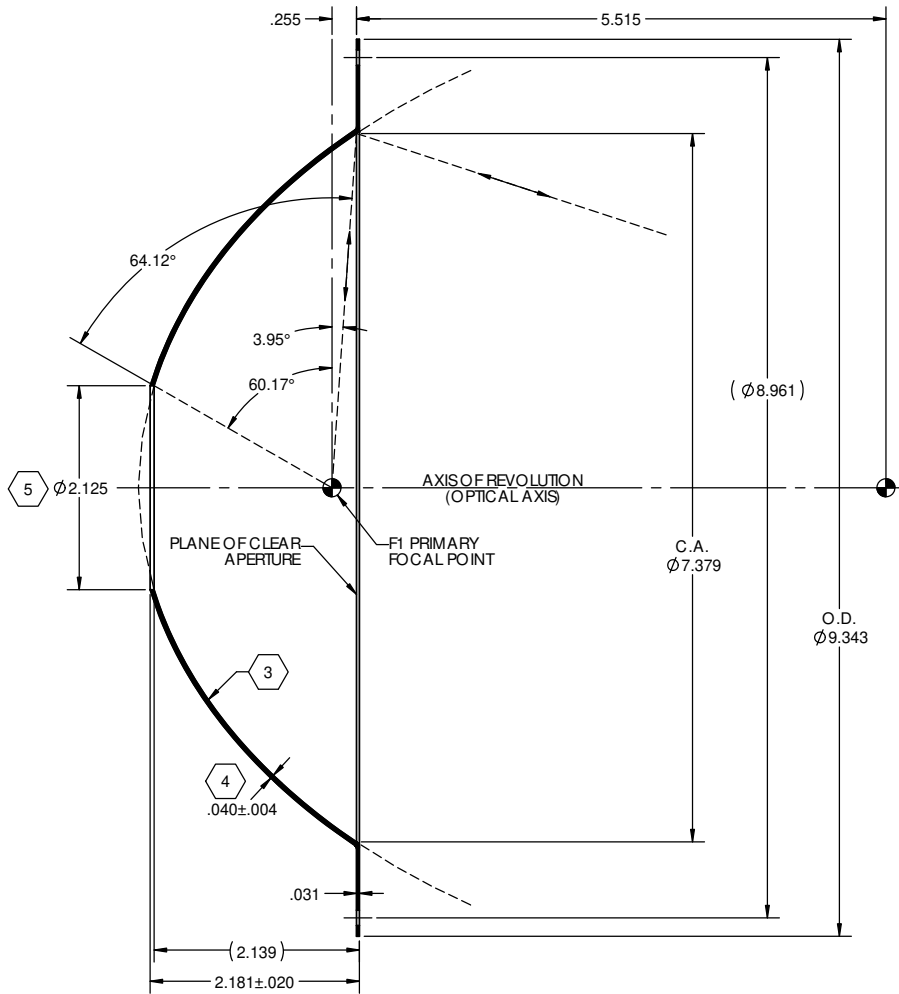

2X Ø .161 FORMED THRU 180° APART ON Ø8.961 BC

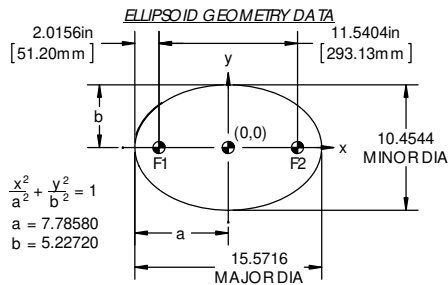

EF SURFACE AREA: 0.5540 SQ. FT.

UNLESS OTHERWISE SPECIFIED DIMENSIONS ARE IN INCHES FRACTIONS ± 1/16 DECIMALS ± .005 TOLERANCE SHOWN		CONTRACT NO. 00-E293		42310 WINCHESTER RD. TEMECULA, CA 92590 WWW.OPTIFORMS.COM	
MATERIAL ELECTROFORMED NICKEL - LSN TYPE 1		APPROVALS JEH	DATE 04/26/12	REFLECTOR, ELLIPTICAL	
FINISH NOTE 3		CHECKED		11.54"/293mm (F1-F2)	
NEXT ASSY	USED ON	ENGR KMT	DATE 04/26/12	SIZE C	CAGE CODE 0Y1Y4
APPLICATION -DO NOT SCALE DRAWING-		DESIGN ACTIVITY		DWG. NO. E293-0100	REV B
			SCALE 1:1	CAD NO. E293	SHEET 1 OF 1