

NOTES: UNLESS OTHERWISE SPECIFIED

- 1 ELECTROFORM REFLECTOR FROM MASTER TOOL WITH SPECULAR SURFACE QUALITY OF 80-50 SCRATCH-DIG PER MIL-PRF-13830B.
- 2 NOMINAL THICKNESS (T) MAY VARY ± T/4 WITHIN .25 OF EDGES.
- 3 REFLECTIVE SURFACE COATING TO BE SEPARATELY SPECIFIED.

REVISIONS			
REV	DESCRIPTION	DATE	APPROVED
Ø	INITIAL DRAWING RELEASE	05/31/96	GFW
A	REVISED DIM TOL	02/11/98	KMT
B	REVISED TOLERANCES	06/30/98	KEN S
C	CORRECTED GEOMETRY DATA	02/01/00	GFW
D	UPDATED DRAWING FORMAT	08/25/17	RRS

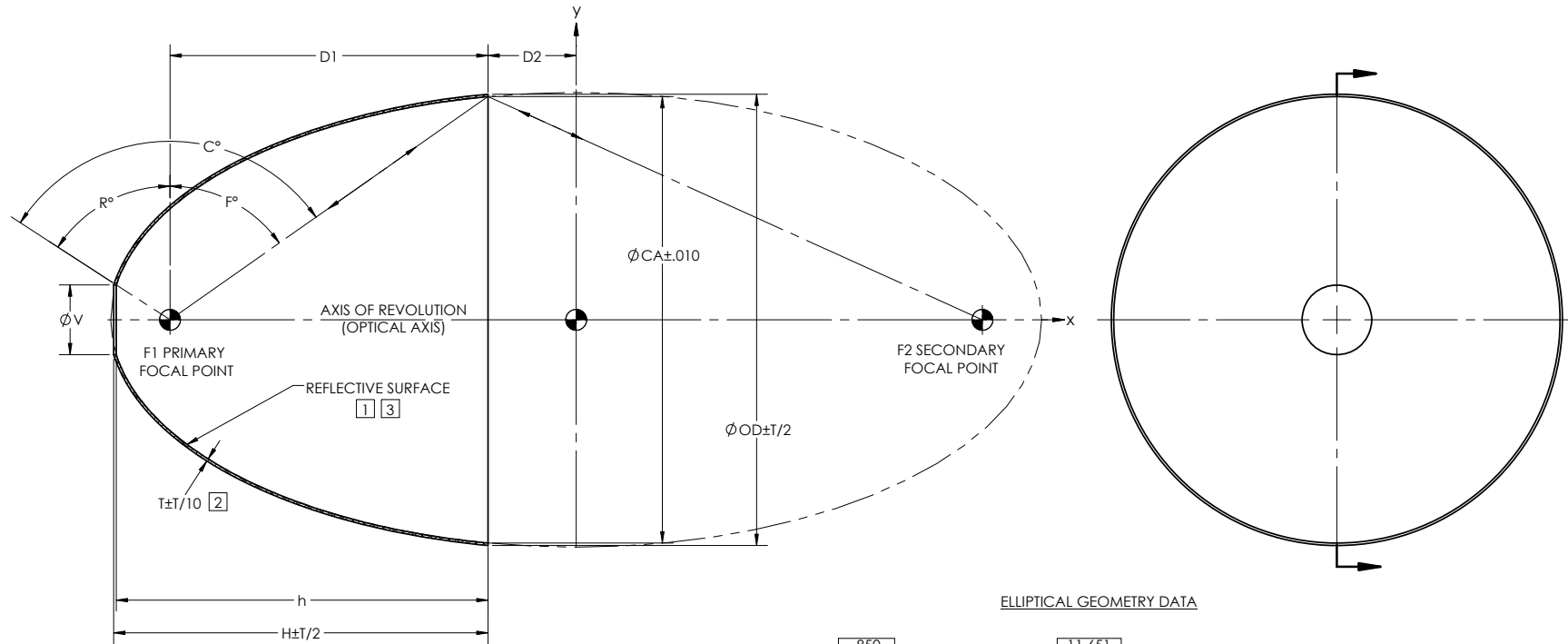

ELLIPTICAL GEOMETRY DATA

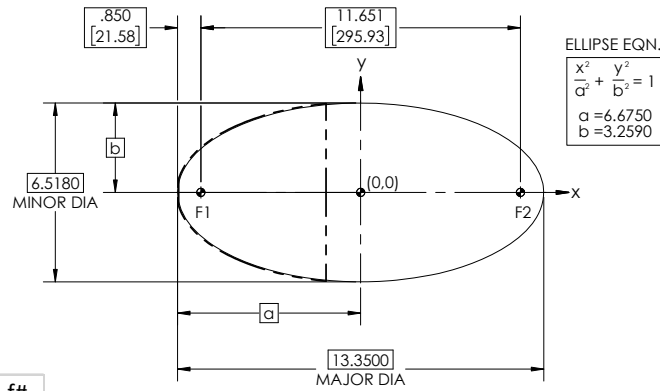

DASH NO.	CA	V	OD	T	D1	D2	H	h	R°	F°	C°	f#
E296	6.400	1.000	6.470	0.035	4.561	1.264	5.368	5.332	57.02	54.95	111.97	1.22
E296-0100	6.400	1.000	6.470	0.035	4.561	1.264	5.368	5.332	57.02	54.95	111.97	1.22
E296-0200	5.000	1.000	5.076	0.035	1.543	4.282	2.350	2.314	57.02	31.69	88.71	2.08
E296-0300	6.400	1.417	6.470	0.035	4.561	1.264	5.289	5.251	44.24	54.95	99.19	1.22

NOTE: THE "E296" DASH NO. IS THE THEORETICALLY LARGEST REFLECTOR THAT CAN BE FORMED FROM EXISTING MASTER TOOLING.

UNLESS OTHERWISE SPECIFIED DIMENSIONS ARE IN INCHES [mm] GD&T PER ASME Y14.5-2009 DO NOT SCALE DRAWING		CONTRACT NO. 00-E296		42310 WINCHESTER RD. TEMECULA, CA 92590 WWW.OPTIFORMS.COM	
FRACTIONS ± 1/16 DECIMALS ± .02 ANGLES ± 1/2° SURFACE ROUGHNESS √/32 DEBURR SHARP EDGES & HOLE RIMS .015 MAX. CHAMFER THREADS .01 PAST ROOT DIAMETER		DRAWN JIW DATE 08/23/17	CHECKED DATE 08/23/17	REFLECTOR, ELLIPTICAL 11.65"/296mm (F1-F2)	
TOLERANCES		ENGR RRS DATE 08/23/17	MATERIAL ELECTROFORMED NICKEL - LSSN TYPE 1		SCALE 4:5 WT. (REF) CAD NO. E296 SHEET 1 OF 1
APPLICATION	THIRD ANGLE PROJECTION	SEE NOTE 3	CAGE CODE 0Y1Y4 E296 REV D		