

NOTES: UNLESS OTHERWISE SPECIFIED

- 1 ELECTROFORM REFLECTOR FROM MASTER TOOL WITH SPECULAR SURFACE QUALITY OF 80-50 SCRATCH-DIG PER MIL-PRF-13830B.
- 2 NOMINAL THICKNESS (T) MAY VARY ± T/4 WITHIN .25 OF EDGES.
- 3 REFLECTIVE SURFACE COATING TO BE SEPARATELY SPECIFIED.

| REVISIONS | | | |
|-----------|-------------------------|----------|----------|
| REV | DESCRIPTION | DATE | APPROVED |
| Ø | INITIAL DRAWING RELEASE | 05/31/96 | GFW |
| A | REVISED DIM TOL | 08/21/17 | KMT |
| B | REVISED TOLERANCES | 08/21/17 | KEN S |
| C | ADDED -12 | 08/21/17 | GFW |
| D | REVISED -7 TO ACTUAL | 08/21/17 | KMT |
| E | ADDED -13 | 08/21/17 | SJM |
| F | ADDED -14 | 08/21/17 | SJM |
| G | ADDED -15 AND -16 | 08/21/17 | RRS |
| H | UPDATED DRAWING FORMAT | 08/21/17 | RRS |

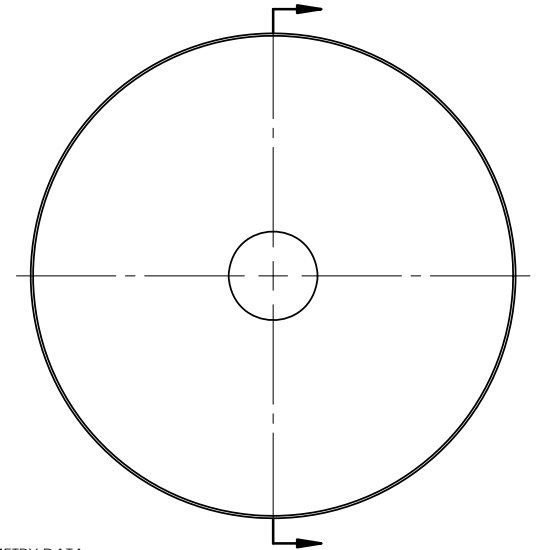
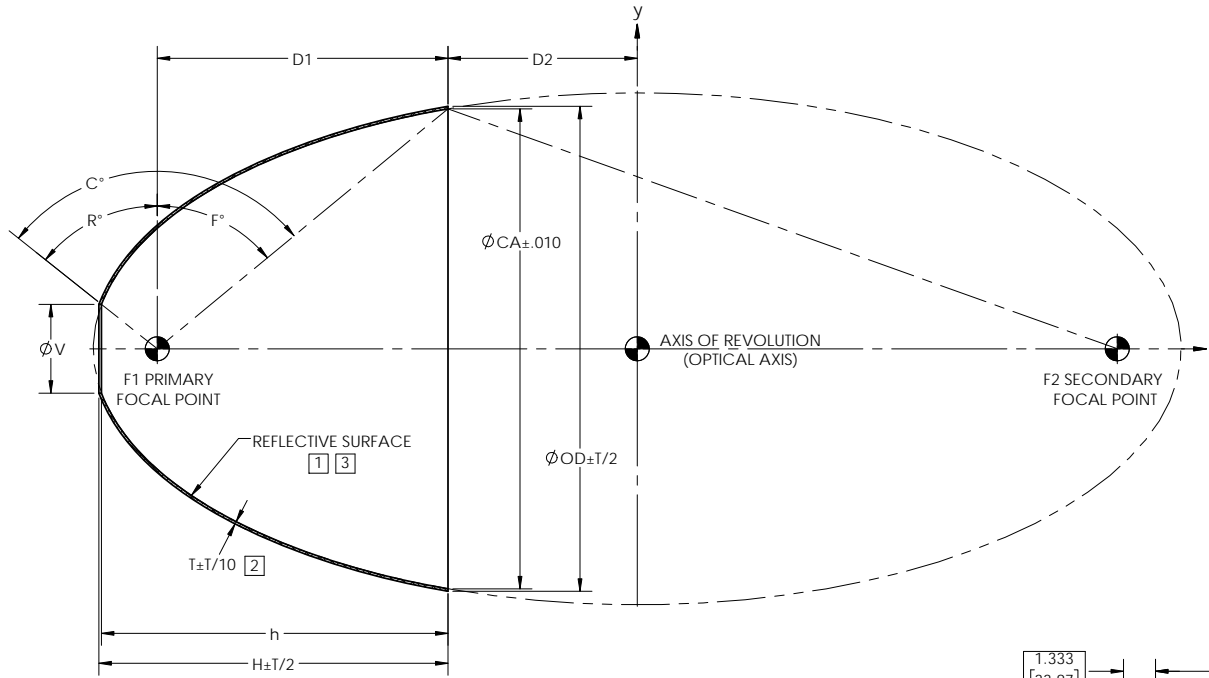

| DASH NO. | CA | V | OD | T | D1 | D2 | H | h | R° | F° | C° | f# |
|-----------|--------|-------|--------|-------|-------|-------|-------|-------|-------|-------|--------|------|
| E508 | 10.000 | 1.850 | 10.101 | 0.050 | 6.056 | 3.944 | 7.271 | 7.218 | 51.47 | 50.46 | 101.93 | 1.48 |
| E508-0100 | 10.000 | 2.250 | 10.081 | 0.040 | 6.056 | 3.944 | 7.178 | 7.135 | 43.79 | 50.46 | 94.24 | 1.48 |
| E508-0200 | 10.000 | 2.500 | 10.081 | 0.040 | 6.056 | 3.944 | 7.119 | 7.074 | 39.15 | 50.46 | 89.61 | 1.48 |
| E508-0300 | 10.000 | 1.850 | 10.081 | 0.040 | 6.056 | 3.944 | 7.260 | 7.218 | 51.47 | 50.46 | 101.93 | 1.48 |
| E508-0400 | 9.300 | 2.250 | 9.383 | 0.040 | 4.450 | 5.550 | 5.572 | 5.528 | 43.79 | 43.74 | 87.53 | 1.75 |
| E508-0500 | 9.300 | 2.500 | 9.383 | 0.040 | 4.450 | 5.550 | 5.512 | 5.467 | 39.15 | 43.74 | 82.89 | 1.75 |
| E508-0600 | 9.600 | 2.250 | 9.682 | 0.040 | 5.060 | 4.940 | 6.182 | 6.138 | 43.79 | 46.51 | 90.30 | 1.63 |
| E508-0700 | 8.815 | 2.000 | 8.889 | 0.035 | 3.618 | 6.381 | 4.789 | 4.751 | 48.55 | 39.39 | 87.94 | 1.92 |
| E508-0800 | 9.300 | 2.400 | 9.403 | 0.050 | 4.450 | 5.550 | 5.548 | 5.492 | 40.99 | 43.74 | 84.73 | 1.75 |
| E508-0900 | 10.000 | 2.000 | 10.081 | 0.040 | 6.056 | 3.944 | 7.232 | 7.189 | 48.55 | 50.46 | 99.01 | 1.48 |
| E508-1000 | 10.000 | 2.750 | 10.081 | 0.040 | 6.056 | 3.944 | 7.052 | 7.006 | 34.65 | 50.46 | 85.10 | 1.48 |
| E508-1100 | 8.375 | 2.000 | 8.460 | 0.040 | 2.981 | 7.019 | 4.157 | 4.114 | 48.55 | 35.45 | 84.00 | 2.09 |
| E508-1200 | 8.000 | 2.000 | 8.087 | 0.040 | 2.504 | 7.496 | 3.679 | 3.636 | 48.55 | 32.04 | 80.59 | 2.24 |
| E508-1300 | 10.000 | 3.200 | 10.081 | 0.040 | 6.056 | 3.944 | 6.915 | 6.867 | 26.89 | 50.46 | 77.34 | 1.48 |
| E508-1400 | 8.815 | 2.750 | 8.889 | 0.035 | 3.618 | 6.381 | 4.609 | 4.569 | 34.65 | 39.39 | 74.03 | 1.92 |
| E508-1500 | 8.375 | 2.750 | 8.460 | 0.040 | 2.981 | 7.019 | 3.977 | 3.932 | 34.65 | 35.45 | 70.10 | 2.09 |
| E508-1600 | 8.000 | 2.750 | 8.087 | 0.040 | 2.504 | 7.496 | 3.500 | 3.454 | 34.65 | 32.04 | 66.69 | 2.24 |

ELLIPTICAL GEOMETRY DATA

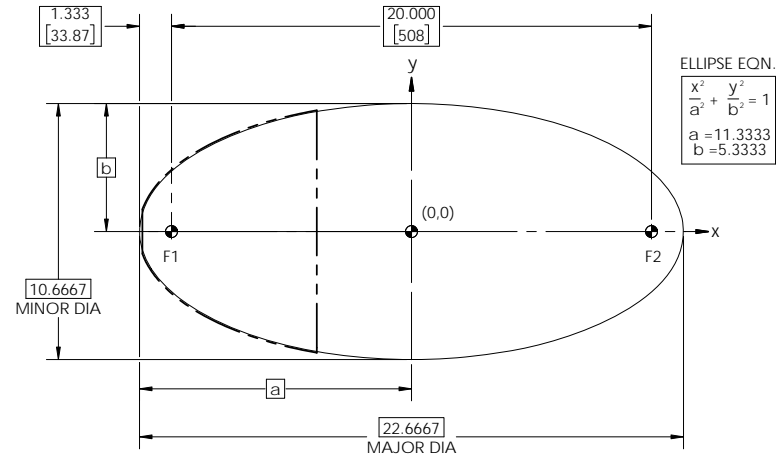

NOTE: THE "E508" DASH NO. IS THE THEORETICALLY LARGEST REFLECTOR THAT CAN BE FORMED FROM EXISTING MASTER TOOLING.

| | | | | | |
|-----------------------------------------------------------------------------------------------------------------|------------------------------------|------------------------|---------------------------------------------|----------------------------------------------------------------------------|--|
| UNLESS OTHERWISE SPECIFIED DIMENSIONS ARE IN INCHES (mm) GD&T PER ASME Y14.5-2009 DO NOT SCALE DRAWING | | CONTRACT NO. 00-E508 | | optiforms® 42310 WINCHESTER RD. TEMECULA, CA 92590 WWW.OPTIFORMS.COM | |
| FRACTIONS ± 1/16 | DECIMALS .XXX ± .02 .XXX ± .005 | ANGLES ± 1/2° | DRAWN JIW DATE 08/21/17 | REFLECTOR, ELLIPTICAL 20.00"/508mm (F1-F2) | |
| TOLERANCES | | | CHECKED DATE | CAGE CODE DWG. NO. OY1Y4 E508 | |
| SURFACE ROUGHNESS | | | ENGR RRS DATE 08/21/17 | REV H | |
| DEBURR SHARP EDGES & HOLES (R0.15 MAX CHAMFER THREADS Ø1 PAST ROOT DIAMETER) | | | MATERIAL ELECTROFORMED NICKEL - LSSN TYPE 1 | SCALE 1:3 WT. (REF) CAD NO. E508 SHEET 1 OF 1 | |
| FINISH | SEE NOTE 3 | THIRD ANGLE PROJECTION | | | |
| NEXT ASSY | USED ON | APPLICATION | | | |