

INFORMATION IN THIS DRAWING IS FOR REFERENCE ONLY

REVISIONS			
REV	DESCRIPTION	DATE	APPROVED
Ø	INITIAL DRAWING RELEASE	09/22/16	JMK
A	REVISED TO CURRENT STANDARDS	09/14/17	JPH

NOTES: UNLESS OTHERWISE SPECIFIED

- REFLECTOR SURFACE QUALITY: ELECTROFORM REFLECTOR FROM MASTER TOOL WITH SPECULAR SURFACE FINISH OF 80-50 SCRATCH-DIG PER MIL-O-13830A.
- MOUNT BONDED TO REFLECTOR USING EPOXY.
- REFLECTOR: ELECTROFORMED - NICKEL LSSN TYPE 1.
MOUNT: 6061-T6 ALUMINUM, BLACK ANODIZE FINISH.

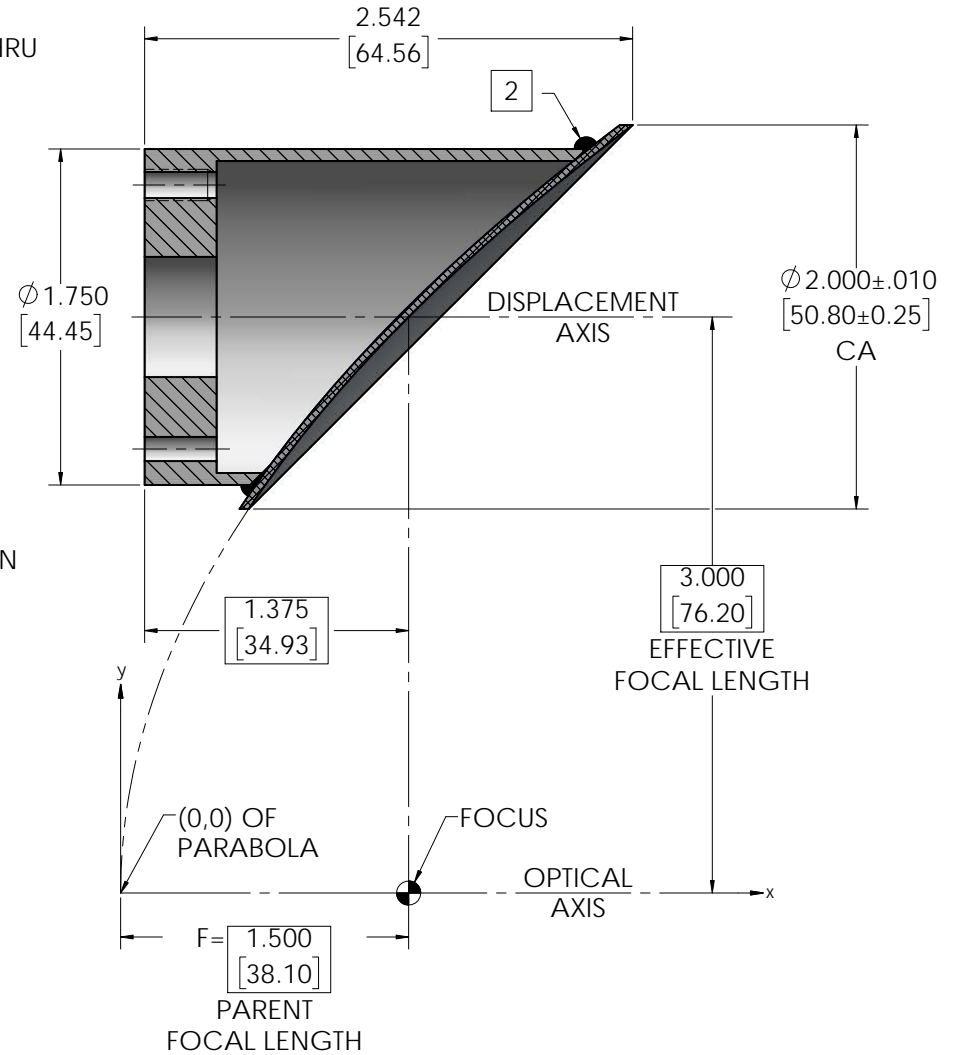
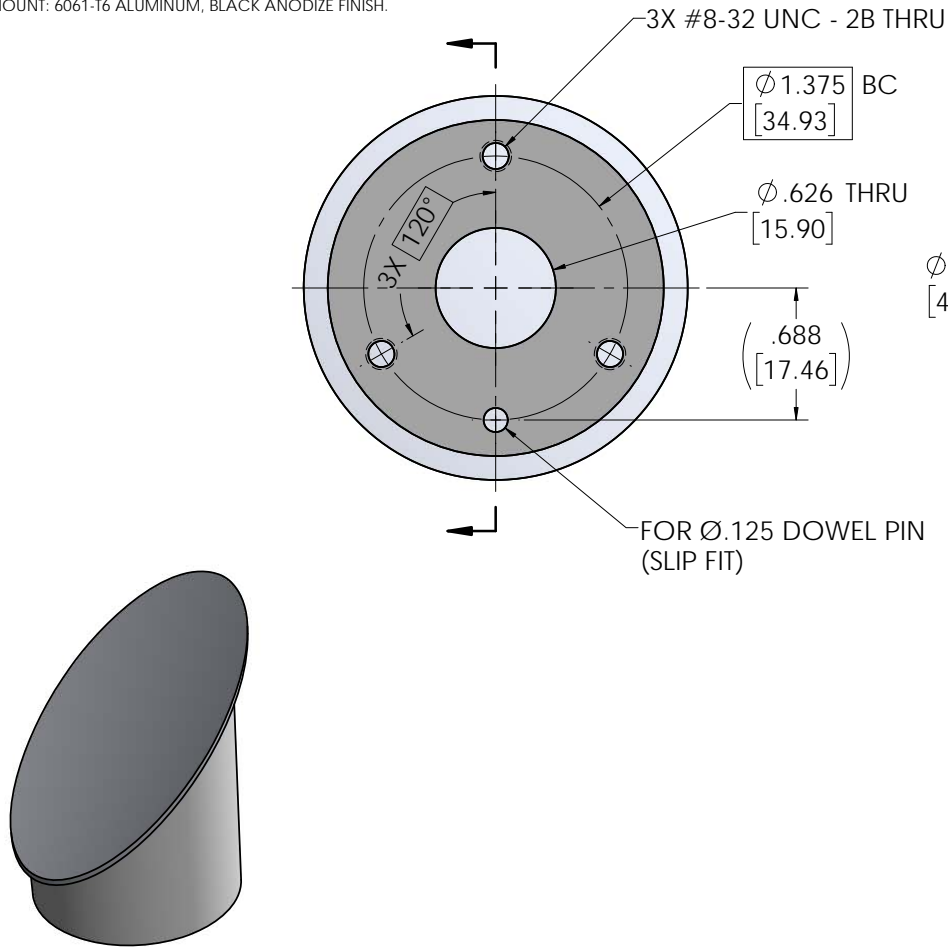

PARABOLA EQN.

$$y^2 = 4Fx$$

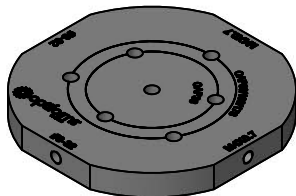

OPTIONAL ACCESSORY:1046-003
(UNIVERSAL OAP ADAPTER 0° OFFSET)

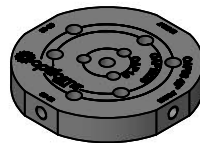

OPTIONAL ACCESSORY:1046-002
(UNIVERSAL OAP ADAPTER 45° OFFSET)

UNLESS OTHERWISE SPECIFIED DIMENSIONS ARE IN INCHES [mm] GD&T PER ASME Y14.5-2009 DO NOT SCALE DRAWING		CONTRACT NO. 88-OAP38		42310 WINCHESTER RD. TEMECULA, CA 92590 WWW.OPTIFORMS.COM	
FRACTIONS ± 1/16	DECIMALS .XXX ± .02	ANGLES ± 1/2°	DRAWN JMK	DATE 09/22/16	optiforms
TOLERANCES			CHECKED	DATE	
SURFACE ROUGHNESS			ENGR KMT	DATE 09/22/16	OFF-AXIS ASSY, PARABOLIC OAP38 SEGMENT
DEBURR SHARP EDGES & HOLES RING .015 MAX. CHAMFER THREADS .01 PAST ROOT DIAMETER			MATERIAL		
THIRD ANGLE PROJECTION			SEE NOTE 3		SIZE C
FINISH			N/A		CAGE CODE 0Y1Y4
SCALE 2:1			WT (REF) 0.17		DWG. NO. OAP38-0000-XXXX
CAD NO. OAP38			SHEET 1 OF 1		REV A