

REVISIONS			
REV	DESCRIPTION	DATE	APPROVED
Ø	INITIAL DRAWING RELEASE	08/08/07	SJM
A	ADDED -03	10/23/07	SJM
B	UPDATED DRAWING FORMAT	07/25/17	JPH

NOTES: UNLESS OTHERWISE SPECIFIED

- 1 ELECTROFORM REFLECTOR FROM MASTER TOOL WITH SPECULAR SURFACE QUALITY OF 80-50 SCRATCH-DIG PER MIL-PRF-13830B.
- 2 NOMINAL THICKNESS (T) MAY VARY ± T/4 WITHIN .25 OF EDGES.
- 3 REFLECTIVE SURFACE COATING TO BE SEPARATELY SPECIFIED.

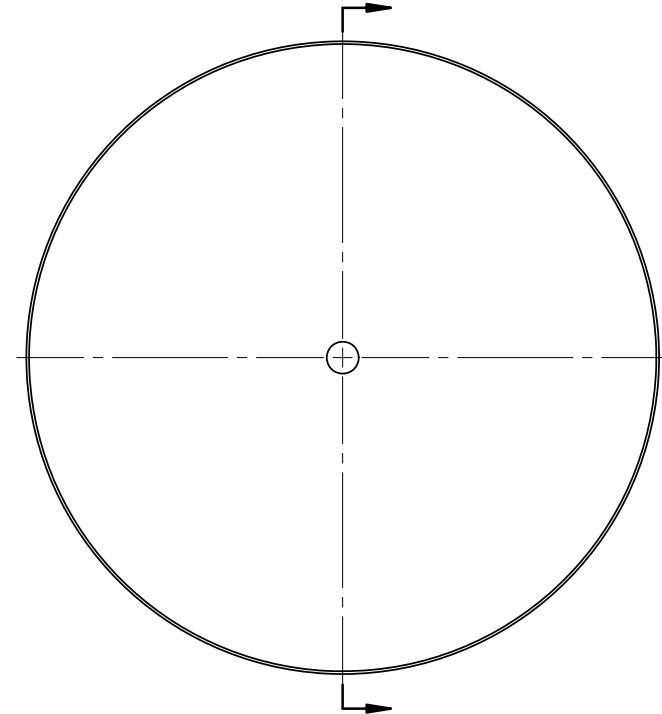
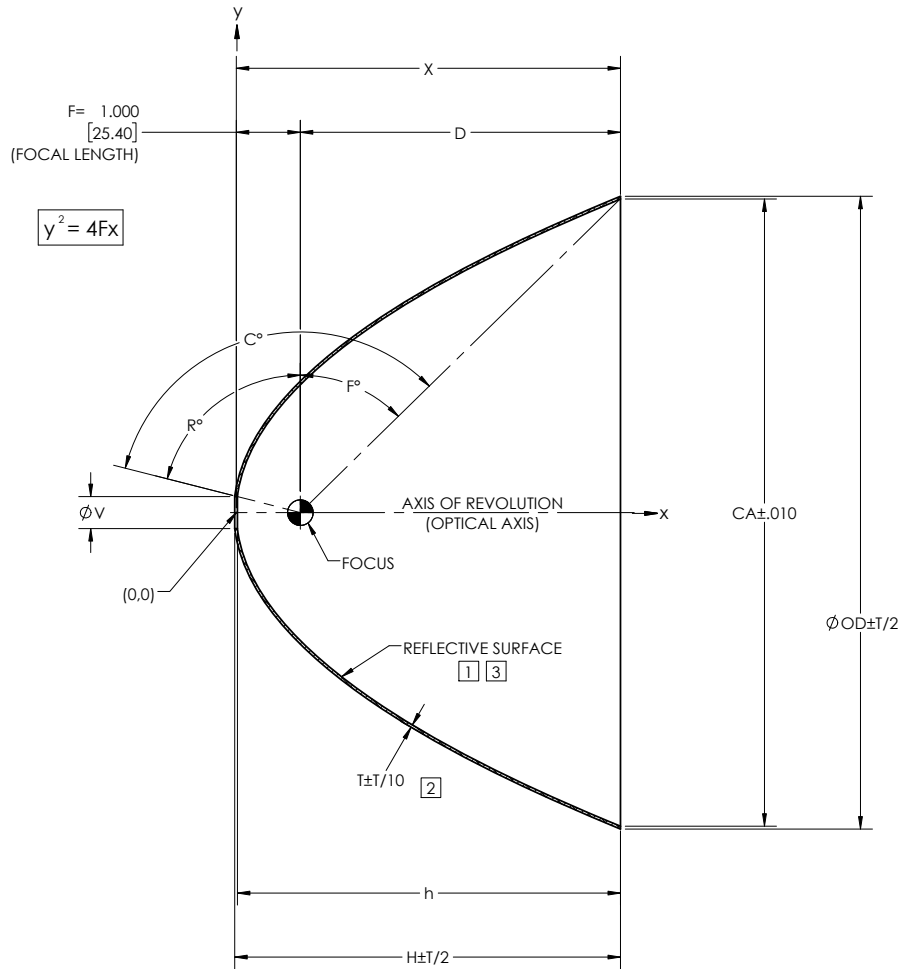

DASH NO.	CA	V	OD	T	X	D	H	h	R°	F°	C°
P25	9.800	0.500	9.886	0.040	6.002	5.002	6.027	5.987	75.75	45.59	121.34
P25-0100	9.800	0.500	9.886	0.040	6.002	5.002	6.027	5.987	75.75	45.59	121.34
P25-0200	9.800	2.000	9.886	0.040	6.002	5.003	5.797	5.752	36.87	45.59	82.46
P25-0300	6.000	1.000	6.072	0.030	2.250	1.250	2.218	2.187	61.93	22.62	84.55
P25-0400	9.800	1.417	9.886	0.040	6.002	5.002	5.919	5.877	50.99	45.59	96.58

NOTE: THE "P25" DASH NO. IS THE THEORETICALLY LARGEST REFLECTOR THAT CAN BE FORMED ON EXISTING MASTER TOOLING.

UNLESS OTHERWISE SPECIFIED DIMENSIONS ARE IN INCHES [mm] GD&T PER ASME Y14.5-2009 DO NOT SCALE DRAWING		CONTRACT NO. 07-P25		42310 WINCHESTER RD. TEMECULA, CA 92590 WWW.OPTIFORMS.COM	
FRACTIONS ± 1/16	DECIMALS ± .02	ANGLES ± 1/2°	DRAWN JIW	DATE 07/25/17	
TOLERANCES SURFACE ROUGHNESS √			CHECKED	DATE	
DEBURR SHARP EDGES & HOLES RINSE 015 MAX. CHAMFER THREADS Ø1 PAST ROOT DIAMETER			ENGR RRS	DATE 07/25/17	<b>REFLECTOR, PARABOLIC</b> 1.00" / 25.4mm FL
MATERIAL ELECTROFORMED NICKEL - LSSN TYPE 1			FRSH	SCALE 2:3	
NEXT ASSY	USED ON	APPLICATION	THIRD ANGLE PROJECTION	SEE NOTES 1.3	SIZE C CAGE CODE 0Y1Y4 DWG. NO. P25 WT. (REF) CAD NO. P25 SHEET 1 OF 1