

REVISIONS			
REV	DESCRIPTION	DATE	APPROVED
Ø	INITIAL DRAWING RELEASE	08/21/07	SJM
A	UPDATED DRAWING FORMAT	07/25/17	JPH

NOTES: UNLESS OTHERWISE SPECIFIED

- 1 ELECTROFORM REFLECTOR FROM MASTER TOOL WITH SPECULAR SURFACE QUALITY OF 80-50 SCRATCH-DIG PER MIL-PRF-13830B.
- 2 NOMINAL THICKNESS (T) MAY VARY ± T/4 WITHIN .25 OF EDGES.
- 3 REFLECTIVE SURFACE COATING TO BE SEPARATELY SPECIFIED.

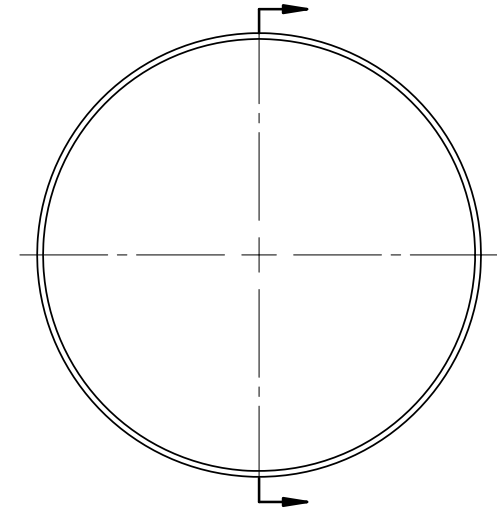
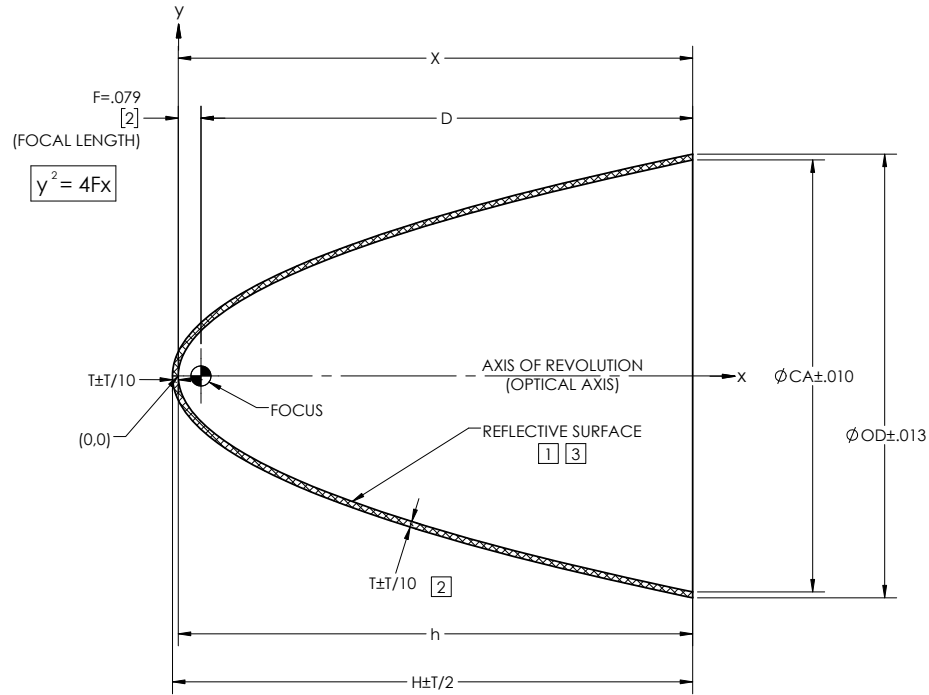

DASH NO.	F	CA	OD	T	X	D	H	h
P2NV	0.07874	1.500	1.5409	0.020	1.786	1.707	1.806	1.786
P2NV-0100	0.07874	1.091	1.1326	0.020	0.945	0.866	0.965	0.945
P2NV-0200	0.07874	1.500	1.5409	0.020	1.786	1.707	1.806	1.786
P2NV-0300	0.07874	1.75	1.7906	0.02	2.431	2.352	2.451	2.431

NOTE: THE "P2NV" DASH NO. IS THE THEORETICALLY LARGEST REFLECTOR THAT CAN BE FORMED ON EXISTING MASTER TOOLING.

UNLESS OTHERWISE SPECIFIED DIMENSIONS ARE IN INCHES [mm] GD&T PER ASME Y14.5-2009 DO NOT SCALE DRAWING		CONTRACT NO. 07-P2		42310 WINCHESTER RD. TEMECULA, CA 92590 WWW.OPTIFORMS.COM	
DRAWN JIW	DATE 07/25/17	DRAWN JIW		DATE 07/25/17	
CHECKED	DATE	CHECKED		DATE	
ENGR RRS	DATE 07/25/17	ENGR RRS		DATE 07/25/17	
FRACTIONS ± 1/16 DECIMALS ± .02 ANGLES ± 1/2° .000 ± .005		SURFACE ROUGHNESS		ELECTROFORMED NICKEL - LSSN TYPE 1	
DEBURR SHARP EDGES & HIDE RIMS .015 MAX. CHAMFER THREADS .01 PAST ROOT DIAMETER		MATERIAL		FINISH	
THIRD ANGLE PROJECTION		SCALE 3:1		CAGE CODE 0Y1Y4	
APPLICATION		SEE NOTES 1,3		DWG. NO. P2NV	
NEXT ASSY		USED ON		REV A	
SCALE 3:1		WT. (REF) 0.039 lbs.		SHEET 1 OF 1	