

NOTES: UNLESS OTHERWISE SPECIFIED

- 1 ELECTROFORM REFLECTOR FROM MASTER TOOL WITH SPECULAR SURFACE FINISH OF 80-50 SCRATCH-DIG PER MIL-O-13830A.
- 2 NOMINAL THICKNESS (T) MAY VARY ± T/4 WITHIN .25 OF EDGES.
- 3 REFLECTIVE SURFACE COATING TO BE SEPARATELY SPECIFIED.
- 4 VERTEX HOLE OPENING IS PREFERRED REGISTRATION FEATURE FOR AXIAL ALIGNMENT OF REFLECTOR PLANE OF CLEAR APERTURE NOT RECOMMENDED FOR THIS PURPOSE.

| REVISIONS |  |          |          |
|-----------|--|----------|----------|
| REV       | DESCRIPTION  | DATE     | APPROVED |
| A         | REV DIMENSION TOLERANCES, ADDED -.05   | 02/10/98 | KMT      |
| B         | REV -.05 TO AGREE W/ PROD., ADDED NOTE 5   | 03/02/98 | KMT      |
| C         | REV DIM TOLERANCES AND NOTES   | 07/01/98 | GFW      |
| D         | ADDED -.06   | 11/09/04 | GFW      |
| E         | INITIAL SOLIDWORKS DRAWING RELEASE. UPDATED TO CURRENT STANDARDS. DELETED NOTES. | 07/07/14 | RFS      |
| F         | ADDED P5-0700 TO TABLE   | 04/13/15 | RFS      |

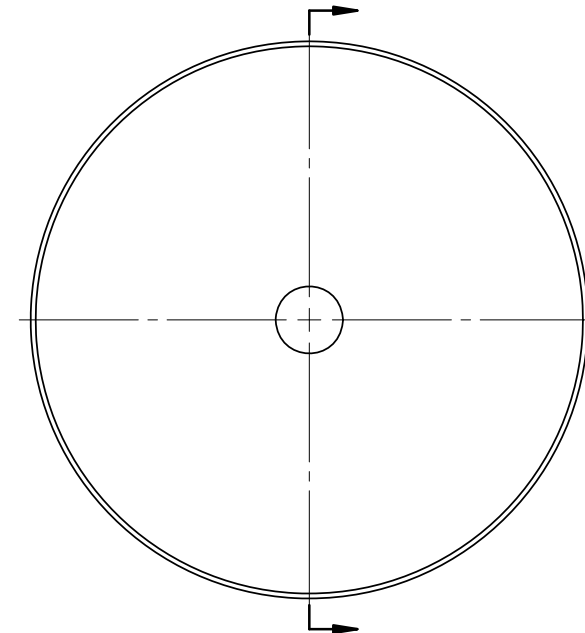
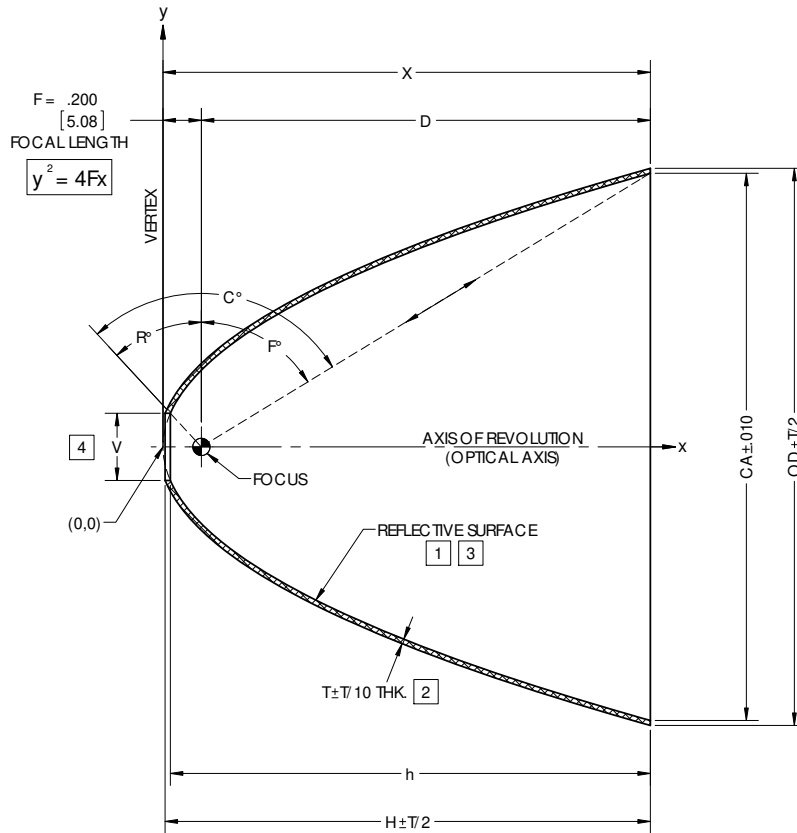

| DASH NO. | CA    | V     | OD    | T     | X     | D     | H     | h     | R°    | F°    | C°     |
|----------|-------|-------|-------|-------|-------|-------|-------|-------|-------|-------|--------|
| P5-0100  | 2.000 | 0.350 | 2.054 | 0.025 | 1.250 | 1.050 | 1.239 | 1.212 | 42.74 | 46.40 | 89.14  |
| P5-0200  | 2.850 | 0.500 | 2.902 | 0.025 | 2.538 | 2.338 | 2.489 | 2.460 | 25.99 | 58.64 | 84.63  |
| P5-0300  | 2.000 | 0.500 | 2.054 | 0.025 | 1.250 | 1.050 | 1.201 | 1.172 | 25.99 | 46.40 | 72.39  |
| P5-0400  | 2.850 | 0.350 | 2.902 | 0.025 | 2.538 | 2.338 | 2.527 | 2.500 | 42.74 | 58.64 | 101.38 |
| P5-0500  | 1.946 | 0.600 | 2.000 | 0.025 | 1.183 | 0.983 | 1.102 | 1.071 | 16.26 | 45.30 | 61.57  |
| P5-0600  | 1.920 | 0.380 | 1.968 | 0.022 | 1.152 | 0.952 | 1.131 | 1.107 | 39.18 | 44.76 | 83.94  |
| P5-0700  | 2.000 | 0.250 | 2.054 | 0.025 | 1.250 | 1.050 | 1.257 | 1.230 | 55.29 | 46.40 | 101.69 |

|   |                |  |               |   |                 |
|---|----------------|--|---------------|---|-----------------|
| UNLESS OTHERWISE SPECIFIED<br>DIMENSIONS ARE IN INCHES (mm)<br>G&S TPER ASME Y14.5-2009<br>DO NOT SCALE DRAWING |                | CONTRACT NO. 96-P5                           |               | 42310 WINCHESTER RD.<br>TEMECULA, CA 92590<br>WWW.OPTIFORMS.COM |                 |
| TOLERANCES  |                | DRAWN GFW                                    | DATE 06/06/96 |   |                 |
| FRACTIONS ± 1/16  | DECIMALS ± .02 | CHECKED                                      | DATE          | <b>REFLECTOR, PARABOLIC</b><br>.200" / 5mm FL                   |                 |
| .XXX ± .005   | ANGLES ± 1/2°  | ENGR KMT                                     | DATE 06/06/96 |   |                 |
| SURFACE ROUGHNESS √   |                | MATERIAL ELEC. TROFORMED NICKEL - LSN TYPE 1 |               | SIZE C  | CAGE CODE 0Y1Y4 |
| DEBURR SHARP EDGES & HOLES RAG 015 MAX. CHAMFER 3:4 ROUNDS 01 PAST FOOT DIAMETER                                |                | FINISH SEE NOTE 3                            |               | WT. (REF)   | P5              |
| THIRD ANGLE PROJECTION  | APPLICATION    | SCALE 2:1                                    | CAD NO. P5    | SHEET   | REV F           |

Ⓡ