

REVISIONS			
REV	DESCRIPTION	DATE	APPROVED
Ø	INITIAL DRAWING RELEASE	01/19/07	KMT
A	ADDED -03	04/24/07	SJM
B	ADDED -04	02/24/11	SJM
C	UPDATED DRAWING FORMAT	07/26/17	JPH

NOTES: UNLESS OTHERWISE SPECIFIED

- 1 ELECTROFORM REFLECTOR FROM MASTER TOOL WITH SPECULAR SURFACE QUALITY OF 80-50 SCRATCH-DIG PER MIL-PRF-13830B.
- 2 NOMINAL THICKNESS (T) MAY VARY ± T/4 WITHIN .25 OF EDGES.
- 3 REFLECTIVE SURFACE COATING TO BE SEPARATELY SPECIFIED.

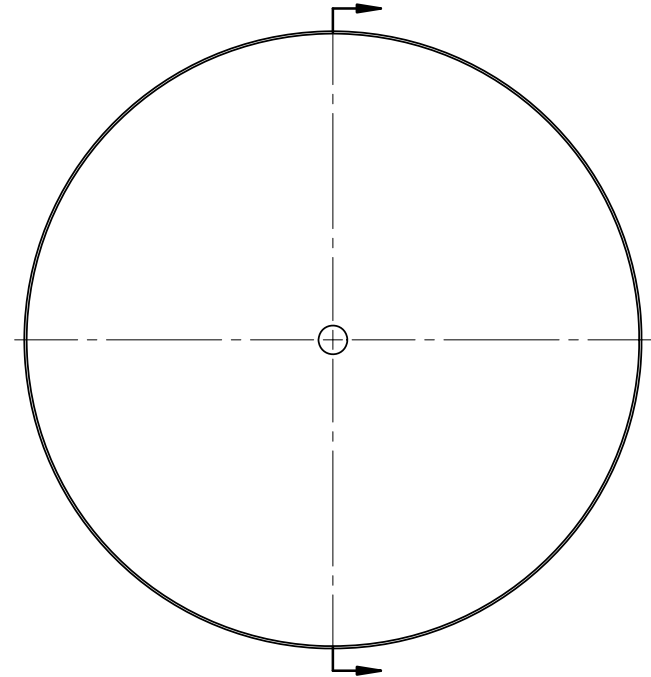
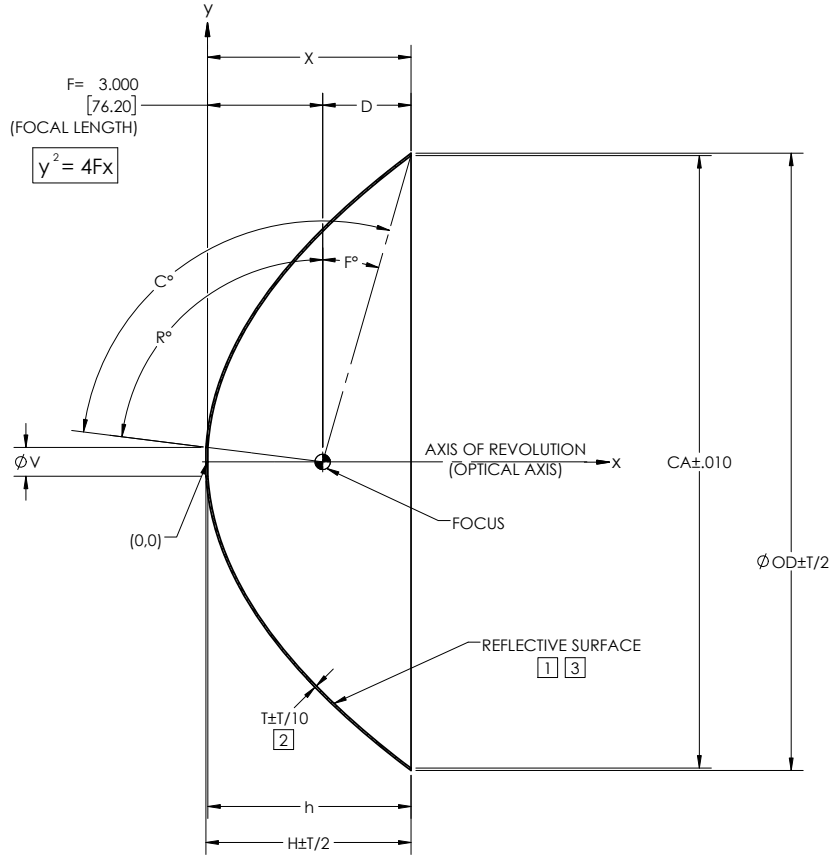

DASH NO.	CA	V	OD	T	X	D	H	h	R°	F°	C
P76	15.950	0.750	16.075	0.050	5.300	2.300	5.338	5.288	82.85	16.09	98.94
P76-0100	14.500	0.750	14.630	0.050	4.380	1.380	4.419	4.368	82.85	10.78	93.63
P76-0200	14.000	2.500	14.132	0.050	4.083	1.083	4.004	3.953	66.46	8.80	75.26
P76-0300	15.950	2.500	16.075	0.050	5.300	2.300	5.221	5.170	66.46	16.09	82.55
P76-0400	12.000	0.750	12.141	0.050	3.000	0.000	3.038	2.988	82.85	180.00	82.85
P76-0500	12.000	2.250	12.141	0.050	3.000	0.000	2.945	2.895	68.76	180.00	68.76

NOTE: THE "P76" DASH NO. IS THE THEORETICALLY LARGEST REFLECTR THAT CAN BE FORMED ON EXISTING MASTER TOOLING.

UNLESS OTHERWISE SPECIFIED DIMENSIONS ARE IN INCHES [mm] GD&T PER ASME Y14.5-2009 DO NOT SCALE DRAWING		CONTRACT NO. 05-P76		42310 WINCHESTER RD. TEMECULA, CA 92590 WWW.OPTIFORMS.COM	
FRACTIONS ± 1/16 DECIMALS ± .02 ANGLES ± 1/2° SURFACE ROUGHNESS √ DEBURR SHARP EDGES & HOLE RIMS: 0.15 MAX. CHAMFER THREADS: 0.1 PAST ROOT DIAMETER		DRAWN JIW DATE 07/26/17	CHECKED DATE	REFLECTOR, PARABOLIC 3.000" / 76mm FL	
TOLERANCES		ENGR RRS DATE 07/26/17	MATERIAL ELECTROFORMED NICKEL - LSSN TYPE 1		SIZE C CAGE CODE 0Y1Y4 DWG. NO. P76
NEXT ASSY USED ON		FRSH		SCALE 2:5	WT. (REF) CAD NO. P76 SHEET 1 OF 1
APPLICATION		THIRD ANGLE PROJECTION		SEE NOTES 1,3	